

Family favourites

With an ever-growing group of relatives descending on their house, Carrie and Tim Mann extended their kitchen space to make teatime a special treat

The rich, warm oak furniture in the Manns' newly extended kitchen adds a touch of timeless tradition to their functional family space. 'I chose to have some cream-painted cabinetry to allow the wooden units to breathe,' explains Carrie. The Berkeley oak furniture from Callerton was stained to match the Amtico Antique Oak flooring



TRADITIONAL

‘Someone told me a family that eats together, stays together and luckily for us, our family loves eating!’



Carrie Mann and her husband Tim, who have a large – and growing – family, live in their beautiful detached home in Hertfordshire with their daughters, Toni, 12, and Ellie, nine. However, they also have three grown-up daughters who frequently visit with their partners and children, so a large kitchen is a must. 'More often than not, there are at least 10 people over on Sunday for dinner,' explains Carrie. 'So our original kitchen-cum-breakfast room really wasn't big enough any more.'

To accommodate the whole clan, Carrie and Tim decided to extend into the garden to create a new kitchen. 'While the building work was going on I still had use of the old kitchen, as it wasn't removed until the new one was installed,' recalls Carrie. 'Much to my dismay, it wasn't at all disruptive, as I thought I might have a few nights off from cooking!'

Remarkably, the design process was equally plain sailing. The Manns were very open-minded in their approach to the new kitchen and

modestly requested just four design features. 'Tim really wanted a breakfast bar, for the times when it's only the four of us eating,' says Carrie. 'I liked the idea of a mantle and a central island, plus there was a wall of integrated appliances on our wish list, too.'

Open to suggestions, they approached three designers with the project, and David Scogings at Cambridge Kitchens came up with an outstanding scheme that the couple couldn't fault. 'It had everything that we wanted and more besides,' enthuses Carrie.

David's oak and painted design extended into the far end of the room embracing each of Carrie and Tim's design ideals, without jeopardising the extra space they had acquired. 'This kitchen is the perfect setting for family life. We held our daughter's engagement party here, with at least 50 guests and we still had room to spare,' says Carrie. 'Someone told me a family that eats together, stays together, and luckily, my family loves eating!'



The highly decorative Berkeley oak mantle elegantly frames the tiled hob area and discreetly hides an extractor fan. The side supports house pull-out spice drawers



Tim wanted to have a breakfast bar for more informal dining in the kitchen. This thick, curved slice of oak is the perfect solution, as it ties in with the design's other wooden elements. For similar blue gloss bar stools try Drinkstuff

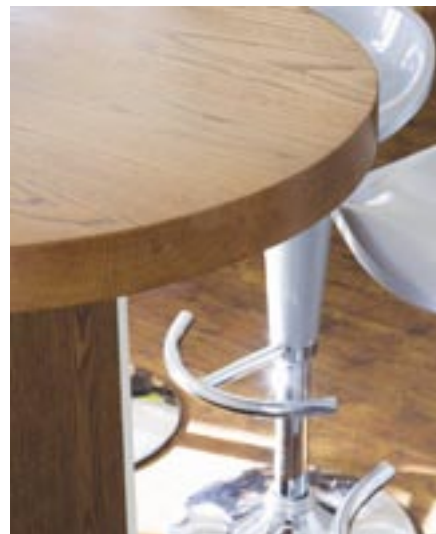

The huge central island is crowned with an enormous slab of Blue Pearl Extra granite measuring 3m x 1.3m. 'Only a small selection of granites were available in this width so we had quite a limited choice,' explains Carrie



Carrie was always keen to incorporate a traditional mantle in her new kitchen and it is her favourite feature. 'It's just such a lovely focal point. I absolutely adore it,' she enthuses. The ornately carved corbels hold a tiered shelf on which Carrie displays gifts from friends



'Think very carefully about the type of flooring you choose.'

Having a dog and an awful lot of feet running through our house meant we needed something practical

Carrie Mann

Where to buy AEG-Electrolux 0870 535 0350 Amtico 0800 667766 Callerton 0191 514 0003 Drinkstuff 0870 428 0958 Elica 01252 351111 Franke 0161 436 6280 Hotpoint 0870 150 6070 Hunsdon Marble 01279 718333 In-Sink-Erator 0800 389 3715 Miele 0845 330 3666 Neff 0870 513 3090 Perrin & Rowe 01708 526361

THE KITCHEN FILE

DESIGN & CABINETRY

- David Scogings at Cambridge Kitchens, 297 Mill Road, Cambridge CB1 3DF (01223 213266) www.cambridgekitchens.co.uk
- Solid Berkeley oak and painted oak furniture from Callerton

WORKTOPS

- Blue Pearl Extra granite, Hunsdon Marble. Price per linear m £370
- 60mm oak. Total cost £1,000

SINKS & TAP

- 2 x ARX11035 undermounted single-bowl sinks in stainless steel, Franke, each £153
- ARX11017 undermounted half-bowl sink in stainless steel, Franke £115
- 4360PF Phoenician monobloc mixer tap in pewter with rinse, Perrin & Rowe £300
- ISE65 waste disposal unit, In-Sink-Erator £350

APPLIANCES (shown)

- 2 x H4431BP Pyrolytic single ovens, Miele, each £1,495
- M8261 combination oven, Miele £705
- T2986 six-burner gas hob, Neff £570
- BI80RM canopy hood with remote, Elica £250
- EGW4060-14 warming drawer, Miele £430
- ESS2060 unheated drawer, Miele £405
- CVA2660 coffee machine, Miele £1,318

APPLIANCES (not shown)

- Integrated fridge drawers, Hotpoint £730
- Integrated larder fridge, AEG-Electrolux £700
- Integrated larder freezer, AEG-Electrolux £700
- Semi-integrated dishwasher, Miele £1,110

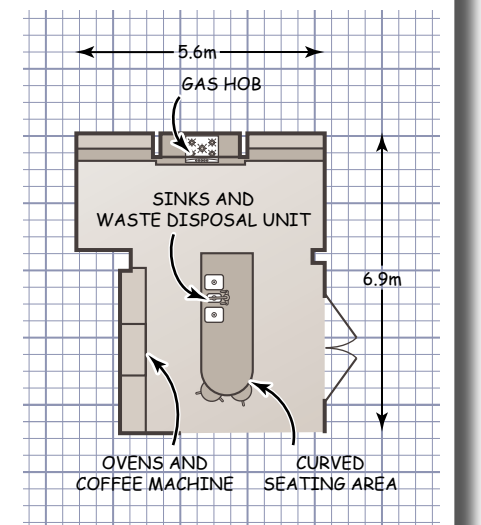

GUIDE PRICE

- Total cost excluding flooring, approx £44,000